

富貴 NIRVANA®

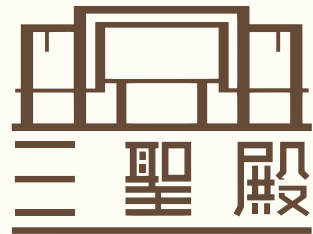

NEW  
LAUNCH  
全新推介



SSD B1 S88

心有归处，静享安然



殿内恭奉弥勒佛为主尊,慈容欢喜,象征包容与宽怀,引领心境回归平和澄明。空间以浅金与象牙白为主调,柔光层叠,墙面层次井然,更显端雅宁谧。天花纹饰线条圆融舒展,如行云流转,呼应“云水自在”的意境,使思念在静谧之中,得到安然寄托。

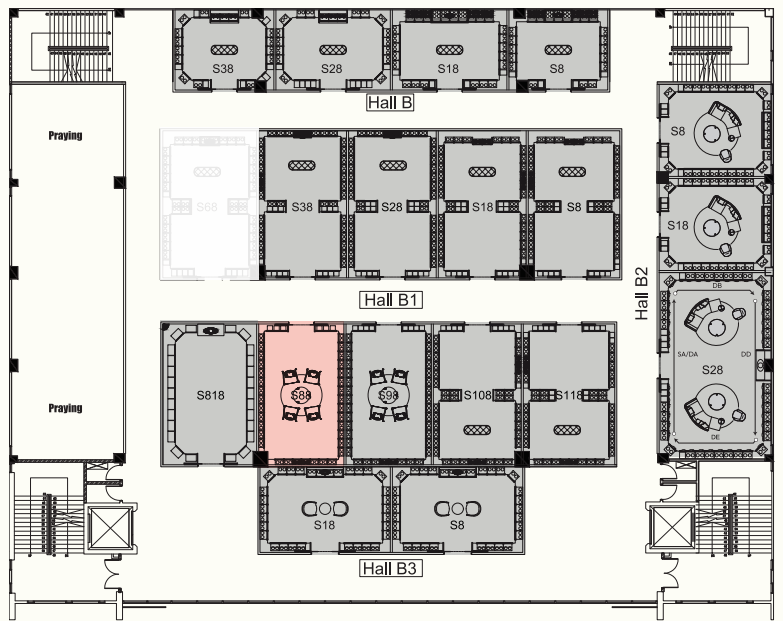

门板以圆形为核心语汇,配合细致金饰纹样,寓意圆满守护。中央浮雕弥勒佛圣像,法相祥和亲切,象征欢喜相伴,愿先人随佛而行,如行云无迹,似流水长清。细腻工艺呈现柔和质感,使整体更显庄重有序,于恒久纪念之间,承载一份安定与祝福。



富贵山庄(古来)有限公司  
NIRVANA MEMORIAL PARK (KULAI) SDN.BHD.  
Lot 766 & 767, Jalan Kota Tinggi (5KM), 81000 Kulai, Johor.

☎ 07-662 1188 / 07-558 6666  
📍 Nirvana Memorial Park Kulai 富贵山庄古来

本文件所包含的所有信息(包括任何说明、规格和插图)均可在本公司、其顾问、工程师、建筑师和/或有关当局的要求并且不预先另行通知下,被修改、变动和更改。本文件不拟向亦不能构成要约或合约的一部分。所有视觉效果、影像、图像、平面图和插图均为画家构想图,仅供说明性参考,不可作为任何法律依据。尽管本公司在提供此信息已采取合理谨慎的措施,惟本公司对任何信息变动或不准确性皆一概不负责。本公司或其代理一概无需对任何人士因依赖此内容而采取的任何行动承担责任。准确买者应该在采取任何行动前,自行查询各方面的相关信息,以满足自身的要求。All information contained herein (including statements, specifications and illustrations) are subject to amendments, variations and modifications without prior notification, as may be required by the Company, its consultant, engineer, architect and/or the relevant authorities, and is not intended to form and cannot form part of an offer or contract. All visuals, images, pictures, plans and illustrations are artist's impressions and for illustrative purposes only. Whilst every reasonable care has been taken in providing this information, the Company cannot be held liable for any variation or inaccuracy. No responsibility is accepted by the Company nor its agent for any action taken in reliance thereon. Before acting on any information, prospective purchasers should make their own enquiries to satisfy themselves on all aspects.

\* 所有图片仅供参考。All images are reference only

\* For full details of the terms and conditions, please refer to the respective purchase orders.

JHR-FLY-00006/2026